

Omega Design's

OmegaSort

Belt-Style Bottle Unscrambler

High Reliability Sorting for Fractional Ounce to Gallon-Size Bottles.

- Various machine configurations available
- Easy adjust belt pulleys for bottle variations
- Non-marring, FDA-approved belting
- Rapid, repeatable changeovers



300+

Bottles per minute



Changeover



FDA-Approved Belts



ounce
to
gallon

Ideal applications: bottles, tottles, jars, tubes, vials, jugs, other

** Speed and changeover will vary per customer's application and options selected.*

★★★★★
MADE IN THE USA

Since 1969

www.omegadesign.com

Tel: 1 (610) 363-6555

OMEGA
DESIGN CORPORATION

OmegaSort

Belt-Style Bottle Unscrambler

Our Value Promise
www.omegadesign.com/value



UTILITIES:

- Voltage: 208/240/480 VAC, 50/60 Hz
- Air: 14-20 SCFM @ 80 psig
- Utilities may vary per client specifications

CONTROLS:

- Allen Bradley PLC
- Allen Bradley Touch Screen HMI
- Allen Bradley AC Motor With VFD

SPEED:

- Up to 300 bottles per minute

STANDARD FEATURES:

- Unique rotary disc style sorter (minimizes air requirements)
- 30 cu.ft. hopper with elevator
- Jam-prevention package (paddlewheel, air jets)
- Leveling legs
- Lubed-for-Life bearings
- Electrical safety Interlocks
- Steel frame with painted protective coating

OPTIONS:

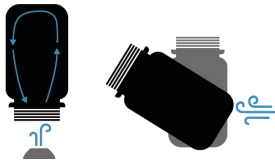

Ionized Air Rinsing

Reject Handling

- Hopper upgrades
- Discharge conveyor and Down Bottle Reject System
- Adjustable and toolless change parts
- UL panel
- Validation support documentation

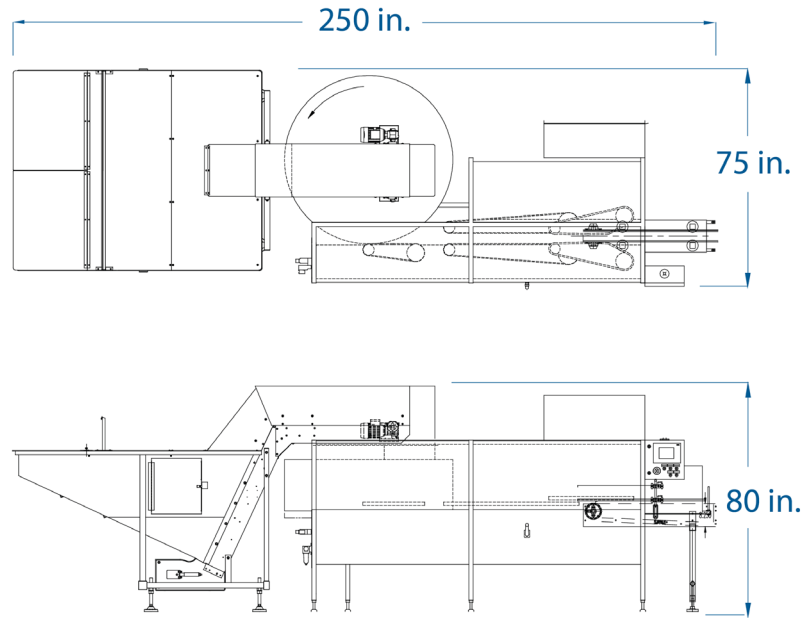

* Layout and dimensions may vary per application.

OPERATION:

An operator loads empty bottles into the standalone hopper. An elevator transports the bottles to the sorter. Bottles engage a series of belt assemblies, which space, orient, and then discharge the bottles onto a conveyor.

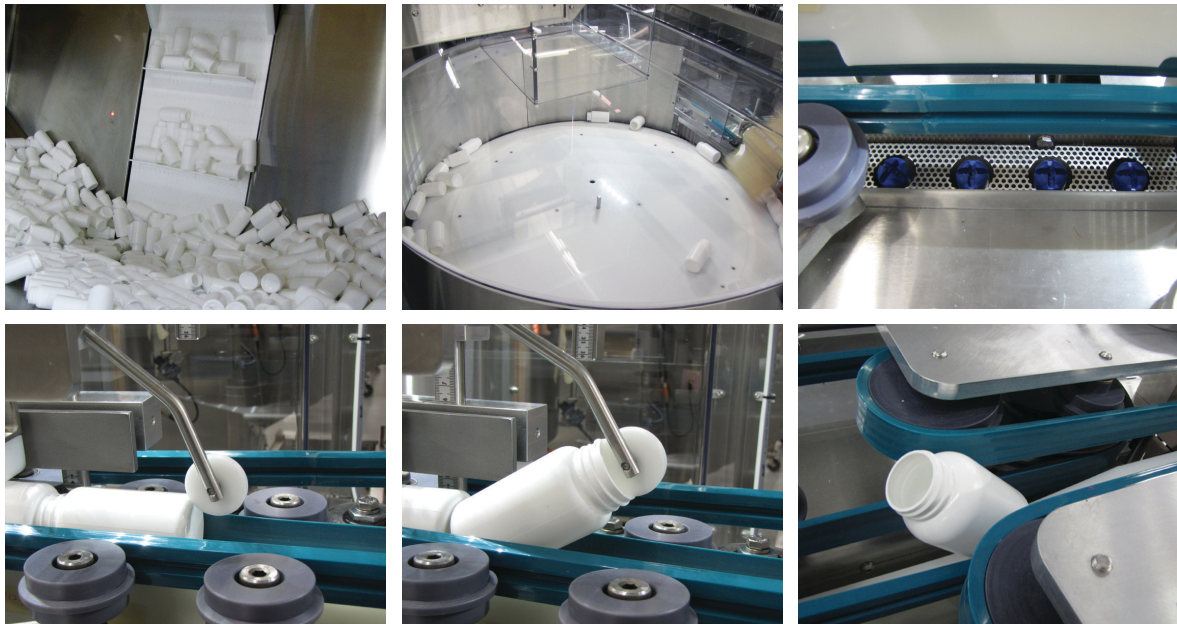

Reminder Ask about our excellent track record of on-time deliveries and industry-leading FATs. Better yet, read what our clients have to say: www.omegadesign.com/testimonials

