

Omega Design's

# Classic DL

## Dual Lane Shrink Bundler

Ultra Compact, Heavy Duty Bundler That Can Last for Generations



- Collates, unitizes and shrinkwraps product
- Ultra compact footprint - smallest in its class
- Sturdy, welded construction (for seal precision over time)
- Open design for easy access and cleaning
- Rapid, repeatable changeovers

1\* or 2

Bundle Lanes



Changeover



Max Bundle Width



Ideal applications: bottles, cartons, consumer goods, novelty

*\* Requires lane conversion upgrade*

★★★★★  
MADE IN THE USA

Since 1969

[www.omegadesign.com](http://www.omegadesign.com)

Tel: 1 (610) 363-6555

OMEGA  
DESIGN CORPORATION

# Classic DL

## Dual Lane Shrink Bundler

Our Value Promise  
www.omegadesign.com/value



OMEGA'S

IMPACT Series

OF PACKAGING EQUIPMENT

- Low cost machine configurations
- Save 20-40% on this machine
- Get faster lead times (6-10 weeks)

**UTILITIES:**

- Voltage: 208/240/480 VAC, 50/60 Hz
- Air: 10-14 SCFM @ 80 psig
- Utilities may vary per client specifications

**CONTROLS:**

- Allen Bradley PLC
- Allen Bradley Touch Screen HMI

**STANDARD FEATURES:**

- Leveling legs (on Bundler)
- Casters (on Heat Tunnel)
- Electrical safety Interlocks and guards
- Steel frame with painted protective coating
- Low pressure sensor
- Lubed-for-Life bearings and no lubrication points
- Hour meter

**OPTIONS:**

- Lane conversion upgrade (between single and dual lanes)
- Micro heat tunnel
- Casters (on Bundler section)
- Broken Film detection
- Down Container detection
- Low Film detection
- Graceport connections
- Hardwire pushbuttons
- Remote E-stop
- Moving rear guides
- 90° container orientation
- Vertical stacker
- Fifth panel carton orientation
- Frame upgrade to stainless steel
- Industrial swing arm for HMI
- UL panel
- Validation support documentation

**OPERATION:**

Product enters the machine from the side. A pneumatic pusher moves two rows of product off the conveyor and into a film web. Once the desired bundle size is configured, a seal is made. The loosely wrapped and sealed bundles then get conveyed through a high temperature heat tunnel, which causes the film to shrink around the bundles.

**LANE CONVERSION UPGRADE:**

Customer can convert the Classic DL to run single or dual lanes of operation.

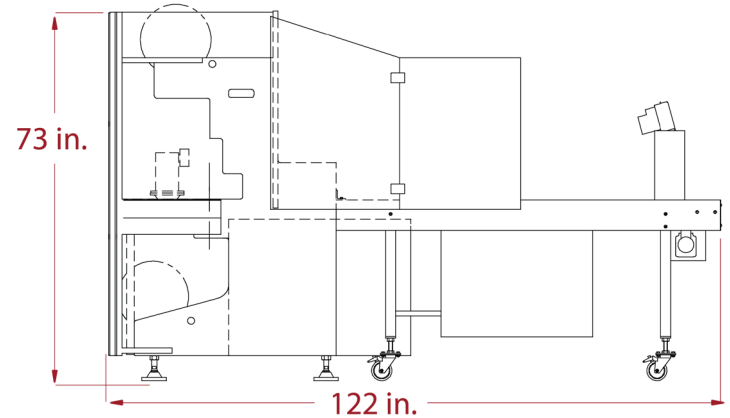
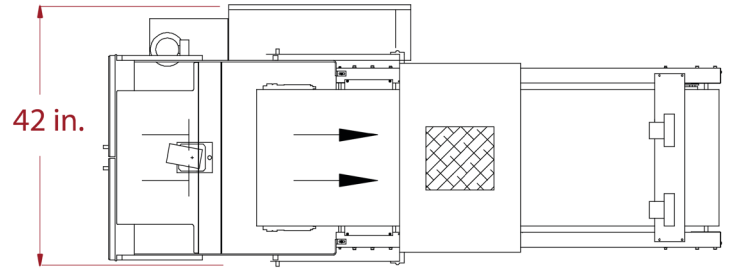
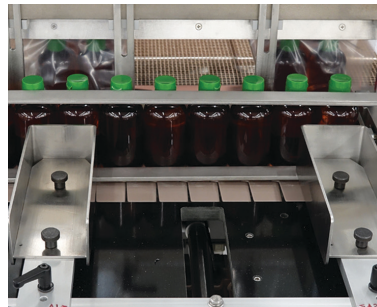

*\* Layout and dimensions may vary per application.*



**Reminder** Ask about our excellent track record of on-time deliveries and industry-leading FATs. Better yet, read what our clients have to say: [www.omegadesign.com/testimonials](http://www.omegadesign.com/testimonials)

